

Custom HOME OF THE WEEK

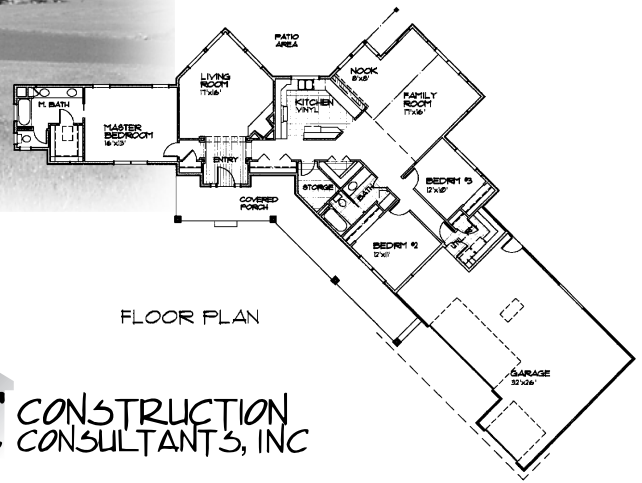

Owners, Tom Ford & Patty Moller

- 1,919 sq. ft. home
- 3 bedrooms, 2 baths
- Family room & formal living
- Separate master suite



Couple's home expresses personal hobbies

Forget all the horror stories you've heard about everything that will go wrong once you decide to build your own home. Tom Ford and Patti Moller had such a surprisingly pleasant experience building theirs, they encourage anyone interested to go ahead and take the leap.

"Our whole experience was very enjoyable," Tom says. "I didn't think we'd ever be living in a place like this, but it's our fantasy come true."

Tom and Patti built their home on a 5+ acre parcel. They had dreamed of this home for quite a while, and had a good idea of what they wanted. In their planning excursions, they had noticed the quality of work done by MC Construction Consultants, Inc., so they decided to meet with them.

"We gave Mike an idea of what we were looking for, showed him our budget,

and two weeks later he called and said he had some plans for us to see," Tom remembers.

Throughout construction, Mike worked with the couple to ensure the house would suit their needs. Raising horses on their property meant a lot of indoor/outdoor traffic, and Tom and Patti decided they would like the southwestern tile they had chosen for their front entry to extend through the halls of the home. They discussed different options with the builder, and were able to make the changes they wanted and still stay within their budget.

Another feature the couple wanted in their home was plenty of windows looking out over their property. The main living areas are oriented and focused on the back side, with windows virtually filling the walls that oversee the acreage behind

the house. This allows them to enjoy the view out their own back door.

And when Patti went looking for accent tile for her kitchen, she was unable to find what she wanted in a style with a finished edge. "Mike came up with an idea to kind of frame the tile trim in cedar," Tom says, "so it not only finished the edges of the tile and set it off nicely, but tied it in with the cedar framed windows in the kitchen and dining area."

The final touch to the home was added when Tom and Patti chose to have their outside concrete work done differently from the average new home. After considering exposed aggregate, they decided instead to go with a rusty colored, dimpled finish concrete that completes the southwestern theme of their design, and helps set their home apart as one of a kind.



Our personalized service includes:

- Custom plan design
- Professional project management
- Quality craftsmanship
- Accurate estimation of your project

CUSTOM HOMES ARE OUR SPECIALTY

360-456-6307 • www.mcconstructionconsultants.com